

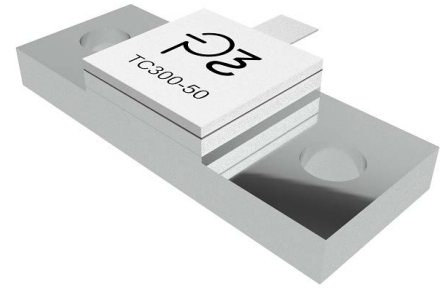

**DC - 3.0 GHz.**

**Model: TC300-XXX**

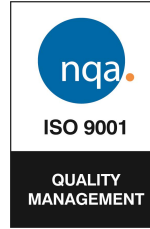

The TC300-50 is a 50 ohm, Beryllium Oxide bolt down termination. It has an input average power of 300 watts, while maintaining a constant mounting surface temperature of 100 °C. It offers a frequency range from DC - 3.0 GHz. with an excellent VSWR of 1.25:1 maximum at 3.0 GHz.

The package is an industry standard which is a direct drop-in replacement for existing legacy products. This allows for easy changeover for new designs and replacing older outdated marginal devices that may have degraded or drifted over time. Applications include Medical, Broadcast, Industrial, Commercial Wireless, Military and Space. 50 Ω is the standard value. We can offer any resistance value from 0-1000 Ω. Please contact the factory for any special requirements.

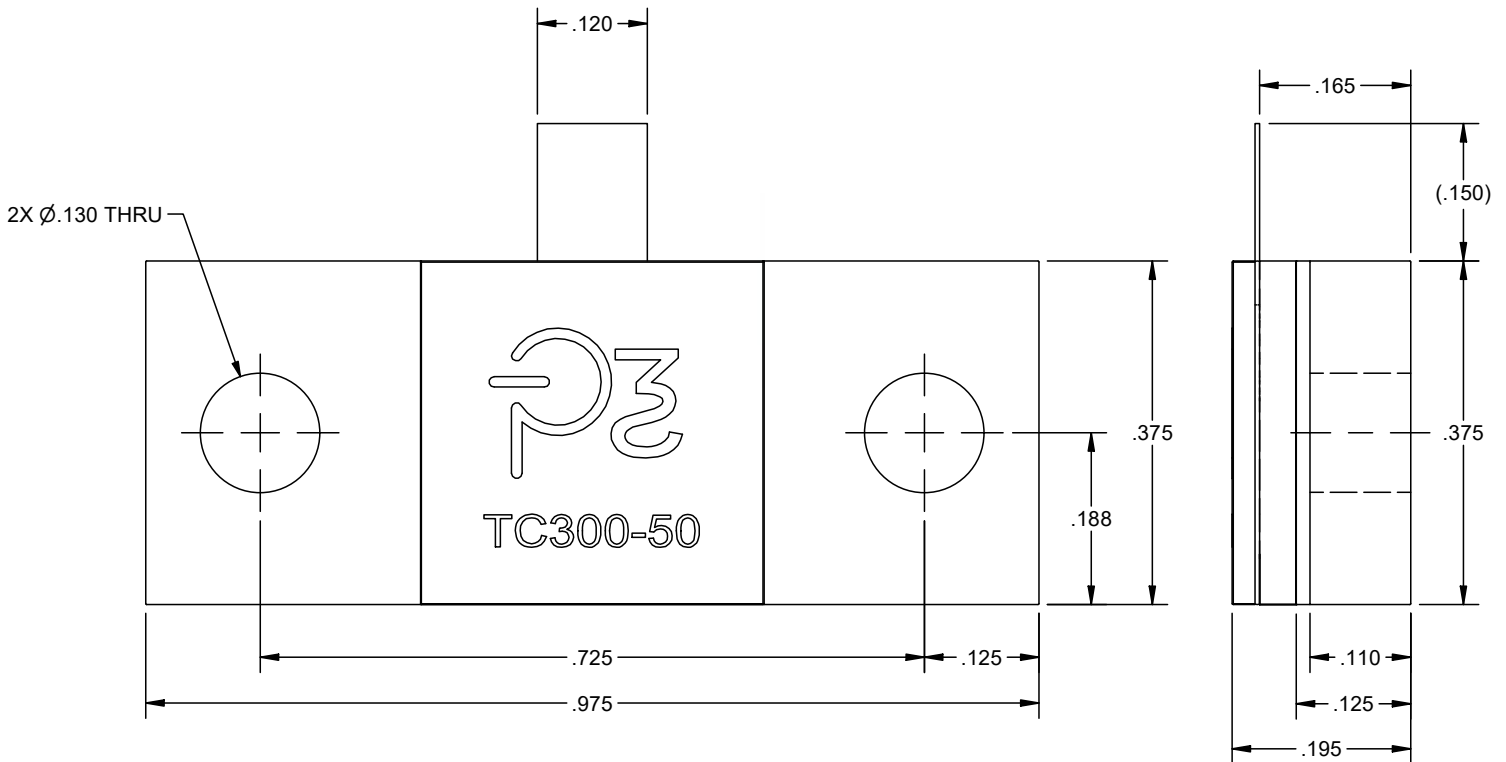

**ELECTRICAL SPECIFICATION**

Frequency Range: DC - 3.0 GHz.  
Impedance: 50 Ω  
DC Resistance: 50 Ω ±5%  
Average Power: 300W (See Power vs Temp. Chart)  
Peak Power: 3.5 kW  
VSWR: 1.25:1 Max.  
Operating Temp.: -55° C to +150° C

**MECHANICAL SPECIFICATION**

Substrate: Beryllium Oxide, 99%  
Resistor: Thick Film  
Flange Material: Copper, Nickel plate per QQ-N-290  
Cover Material: 96% Alumina  
Storage Temp: -55° C To +175° C  
Part Numbering: **TC 300 - XXX**  
**Series Watts Resistance (Ω)**



### Typical Performance Data

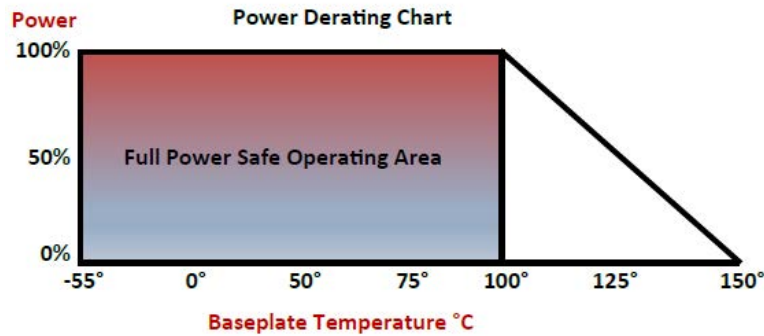
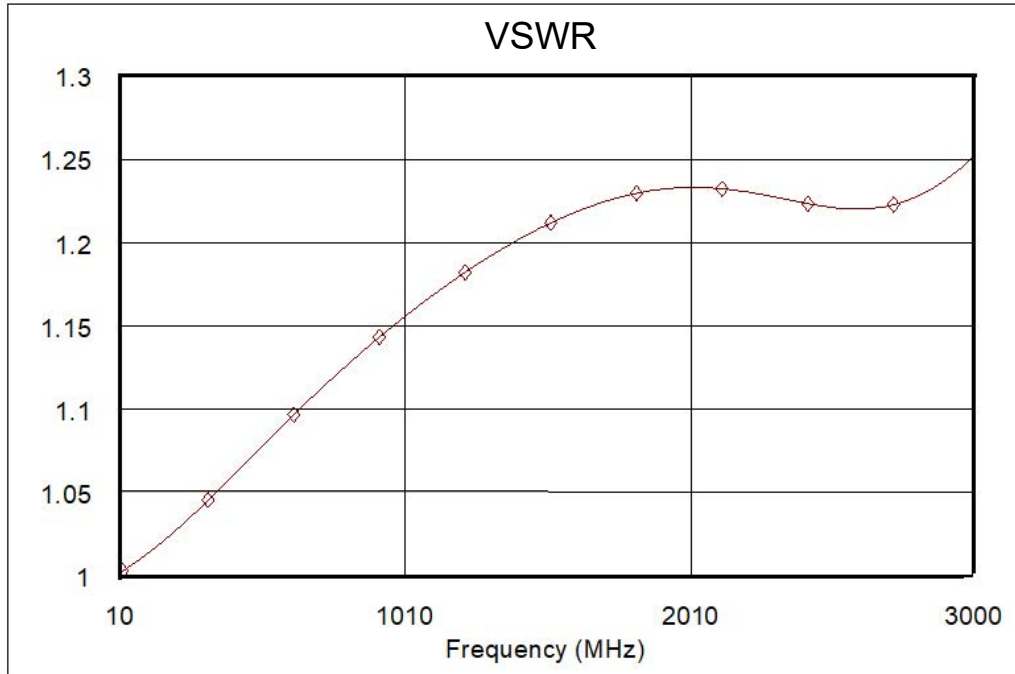

### Mechanical Mounting

THREAD SIZE	TORQUE SETTING
2-56	4 inch-pounds
4-40	6 inch-pounds
6-32	8 inch-pounds
8-32	12 inch-pounds

### SUGGESTED MOUNTING AND TAB STRESS RELIEF METHOD

